

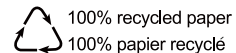

## **EZ.Mi Series**

UHF True Diversity Wireless Microphone System



Installation and Operation

# Contents

01 Safety Operation and Notice .....	P3
02 System Performance Feature .....	P4
03 Packing List .....	P5
04 Receiver Front Panel Function Introduction .....	P6
05 Receiver Rear Panel Function Introduction .....	P8
06 Transmitter Function Introduction .....	P10
Handheld microphone (EZ.H8) .....	P10
Bodypack transmitter (EZ.B8) .....	P12
07 Receiver Device Installation .....	P14
08 Transmitter Battery Installation .....	P15
09 User-friendly steps .....	P16
10 Technical Specification .....	P26

Thank you for choosing a RELACART UHF wireless microphone system. You have joined thousands of other satisfied customers. Our years of professional experience of design and manufacturing to ensure our products' quality, performance and reliability.

## 01 Safety Operation and Notice

1. Please read instructions for safety operation carefully before installation and operation. Please save your safety operation guide for future reference.
2. Do not scratch, bend, twist, stretch or heat the power cord as this may cause damage to the power cord, resulting in a fire or electric shock.
3. Do not open the device shell, otherwise it may cause electric shock. If you need to repair, maintain or repair, please contact your local agent.
4. Do not touch the power plug with wet hands as this may cause a fire or electric shock.
5. Do not attempt to modify this device. Failure to do so may result in personal injury or product malfunction.
6. Do not use this equipment near water.
7. If the power cord is damaged (such as a broken wire or bare core), obtain replacement parts from your dealer. Continued use of the equipment with a damaged power cord may result in fire or electric shock.
8. To move the device he power, unplug the power cord, and unplug all connecting cables as this may damage the cable, resulting in a fire or electric shock.
9. Before cleaning the device, unplug the power cord and unplug all connecting cables. Please clean it with a dry soft cloth.
10. If the device is not in use for a long time, turn off the power, it is best to unplug the socket.
11. With the power plug and appliance coupler as the disconnecting device, it should be kept easy to operate.
12. For the safe use of the equipment and adequate ventilation, the minimum clearance around the equipment should be maintained at a distance of 5 cm or more.
13. DO NOT cover the Ventilation holes, such as: newspaper / fabric / curtains and other items.
14. Equipment should not be placed on a bare flame source, such as: lit candles.
15. Battery should not be exposed to sunshine, roasted or other high temperature overheating environment.
16. Do not throw the waste battery, please put in the designated bins.
17. Water protection rating: IPX0
18. The device can be used normally in tropical / temperate climates.
19. This product is only suitable for safe use at the altitude of 2000m and below.
20. This symbol “⚡” indicates that dangerous voltage constituting a risk of electric shock is present within this unit.
21. All Relacart products will be afforded one year free maintenance except for man-made damage, such as:
  - the device is damaged by man-made factors.
  - the device is damaged by improper operation.
  - some components are damaged or loss after the self-disassembly.

## 02 System Performance Feature

The EZ.Mi series is a UHF wireless microphone system that delivers professional-quality sound and high cost-effective with simple setup and an intuitive interface. The transmitter uses a simple and bright LCD display to display the current channel and battery power. The receiver also uses a high-brightness LED digital tube to display the corresponding product information. The infrared interface automatically synchronizes the frequency and locks the selected application frequency. The receiver is available in single, dual and quad-channel versions, and uses a standard all-metal chassis design to support volume adjustment, channel adjustment and other functions. Suitable for commercial performances, schools, government and enterprise projects, personal and home entertainment applications.

### Key Features:

- UHF Single channel, Dual channel and Quad-channel wireless transmission, providing high-fidelity audio sources.
- Adopt true diversity long-distance technology.
- Widely applicable to commercial performances, schools, government and enterprise projects, personal and family entertainment applications.
- DSP digital audio companding, using 48KHz audio sampling rate, to minimize the noise in the wireless transmission system.
- Output volume and frequency channel adjustment.
- Multiple switchable frequency to achieve operation without environmental interference.
- Use LCD and LED display to show corresponding product information

## 03 Packing List

### EZ.Mi1

- ◆ Wireless microphone receiver \* 1
- ◆ Wireless transmitter \* 1
- ◆ BNC Antenna \* 2
- ◆ External power adapter \* 1
- ◆ 1 meter audio cable \* 1
- ◆ 1.5V AA battery \* 2
- ◆ Rack mount kit (screw) \* 1 set
- ◆ Installation and operation \* 1

### EZ.Mi2

- ◆ Wireless microphone receiver \* 1
- ◆ Wireless transmitter \* 2
- ◆ BNC Antenna \* 2
- ◆ External power adapter \* 1
- ◆ 1 meter audio cable \* 1
- ◆ 1.5V AA battery \* 4
- ◆ Rack mount kit (screw) \* 1 set
- ◆ Installation and operation \* 1

### EZ.Mi4

- ◆ Wireless microphone receiver \* 1
- ◆ Wireless transmitter \* 4
- ◆ BNC Antenna \* 4
- ◆ External power adapter \* 1
- ◆ 1 meter audio cable \* 2
- ◆ 1.5V AA battery \* 8
- ◆ Rack mount kit (screw) \* 1 set
- ◆ Installation and operation \* 1

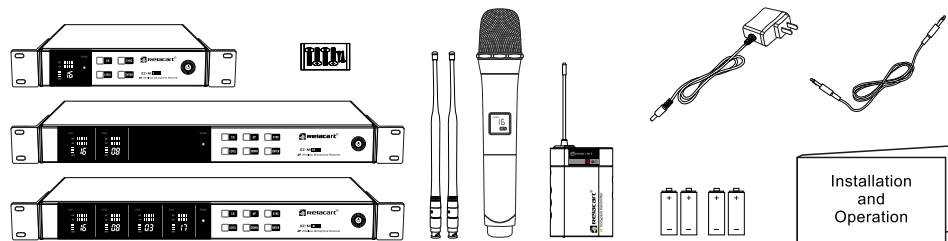

## 04 Receiver Front Panel Function Introduction

(EZ.Mi1 Single channel)

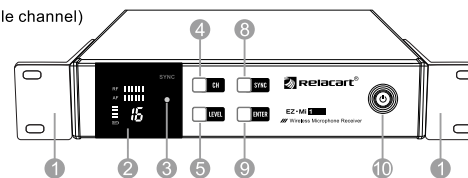

(EZ.Mi2 Dual channel)

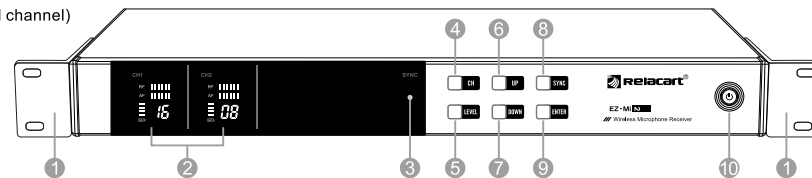

(EZ.Mi4 Quad channel)

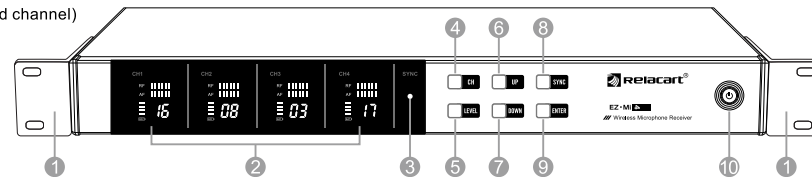

## 05 Receiver Rear Panel Function Introduction

- ❶ Rack mount bracket: Fixed installation.
- ❷ Digital LED display: Display current channel, battery life, RF and AF input status.
- ❸ Infrared [iR] window: Used to send infrared signals to the transmitter for synchronization.
- ❹ “CH” button: EZ.Mi1: Long press to enter the channel Settings.  
EZ.Mi2/EZ.Mi4: Long press to enter the channel selection state, short press to select the channel.
- ❺ “LEVEL” button: EZ.Mi1: Long press to enter the audio level setting.  
EZ.Mi2/EZ.Mi4: Long press to enter the channel level setting state, short press to select the channel level.
- ❻ “UP” control button: Press this button to set the channel or level value in the currently selected independent channel, and it needs to be used with the “CH / LEVEL” button.
- ❼ “DOWN” control button: Press this button to set the channel or level value in the currently selected independent channel, and it needs to be used with the “CH / LEVEL” button.
- ❽ “SYNC” synchronization button: When the receiver and transmitter infrared frequency windows are aligned, press this button again to transfer the setting value from the receiver to the transmitter synchronously. ( \* EZ.Mi2 and EZ.Mi4 need to be used with the “CH” button ❹ in the picture)
- ❾ “ENTER” confirmation button: Press this button to confirm the operation setting.
- ❿ Power switch: Turn on the receiver of power supply, long press to turn off the receiver.

(EZ.Mi1 Single channel)

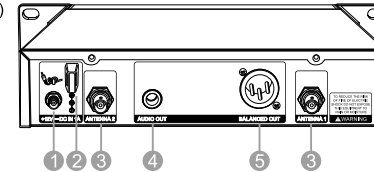

(EZ.Mi2 Dual channel)

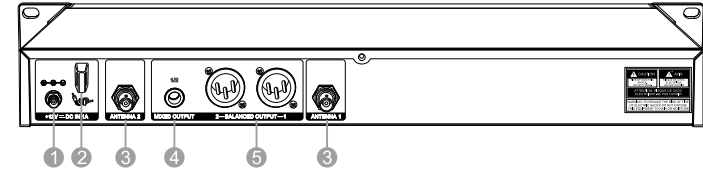

(EZ.Mi4 Quad channel)

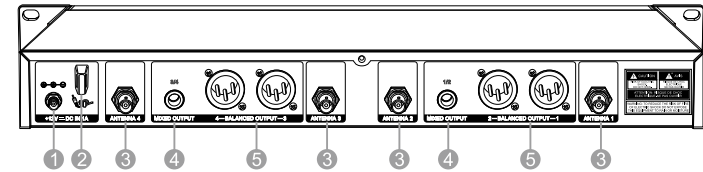

## 06 Transmitter Function Introduction

- ❶ DC IN socket: Connect an external power adapter.
- ❷ Anti-pull device: Used to fix the connecting cable of the external power adapter.
- ❸ RF Antenna Diversity BNC Input Connector: Suitable for the connection of Antenna 1, Antenna 2, Antenna 3, and Antenna 4, used to receive the radio waves transmitted by the transmitter.
- ❹  $\Phi 6.3\text{mm}$  unbalanced dual-channel mixed audio output port. (\* EZ.Mi2/EZ.Mi4: dual-channel mixed output)
- ❺ Balanced XLR audio output ports: Output each channel audio separately.

Handheld microphone (EZ-H8)

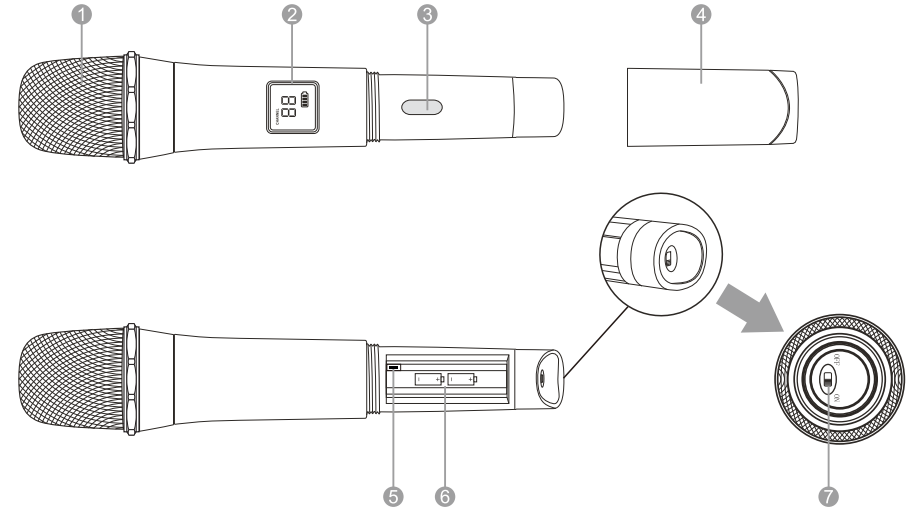

- ❶ Microphone Head: It is the important part to transfer sound into audio signal.
- ❷ LCD display: Display the working channel and battery status. Battery indicator displays a maximum of 4 bar segments. When it leaves 1 bar segment, the batteries should be replaced immediately.
- ❸ Infrared data transmission window (iR): During the infrared synchronization process, aiming at the infrared port of the receiver allows the transmitter to synchronize with the receiver.  
\* During infrared paring, the tail cover must be unscrewed; otherwise, the pairing function may be affected.
- ❹ Handle: unscrew to reveal the battery compartment; when installing or replacing batteries or setting infrared frequency binding, the handle must be opened.
- ❺ RF power switch: HI for high power, LOW for low power.
- ❻ Battery compartment: 2 AA batteries can be loaded. (It is best to use alkaline 1.5V AA batteries, please replace two batteries at the same time when replacing new batteries.)  
Warn: Observe correct polarity as marked inside the battery compartment to avoid damage to the internal electric parts.
- ❼ Power switch: Pull switch to turn on or off the power supply to the transmitter.

### Bodypack transmitter (EZ-B8)

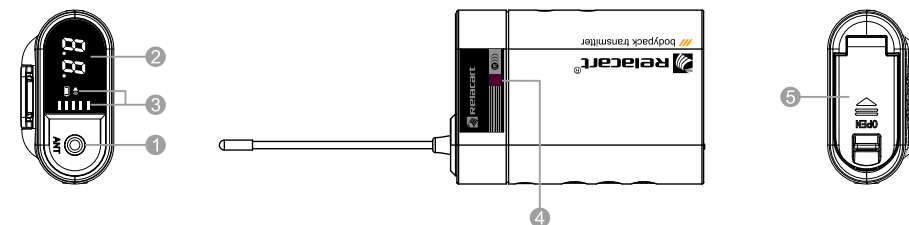

- ❶ External antenna: 1/4 wavelength antenna.
- ❷ Digital LED display: Display current channel.
- ❸ LED status indicator: Display current battery life and AF input status.
- ❹ Infrared data transmission window (iR): During the infrared synchronization process, aiming at the infrared port of the receiver allows the transmitter to synchronize with the receiver.
- ❺ Battery Compartment: Open the battery door by sliding the switch and insert 2 fresh 1.5V AA batteries. (Alkaline type is recommended. Please remember to replace both batteries.)  
Warn: Observe correct polarity as marked inside the battery compartment to avoid damage to the internal electric parts.

## 07 Receiver Device Installation

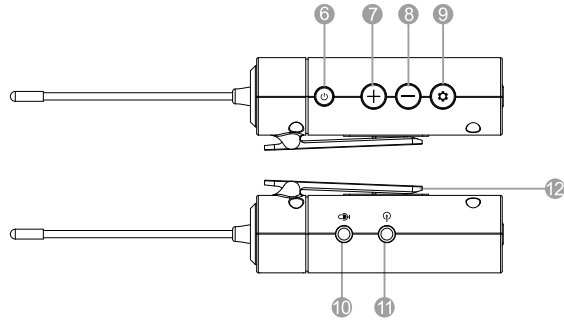

- ⑥ Power switch: Long press for two seconds to turn on and off the power of the device.
- ⑦ “+” button: Volume gain.
- ⑧ “-” button: Volume attenuation.
- ⑨ “SET” button: Long press to enter the volume setting (flashing), and use the “+/-” button to change the volume value.
- ⑩ 3.5mm microphone input jack: For connecting lavalier microphone.
- ⑪ 3.5mm line input jack: For connecting musical instrument or audio equipment (such as guitars or computers).
- ⑫ Fixing clip: Used to fix the waist pack around the user's waist or on objects such as guitar straps.

(EZ.Mi4 Quad channel)

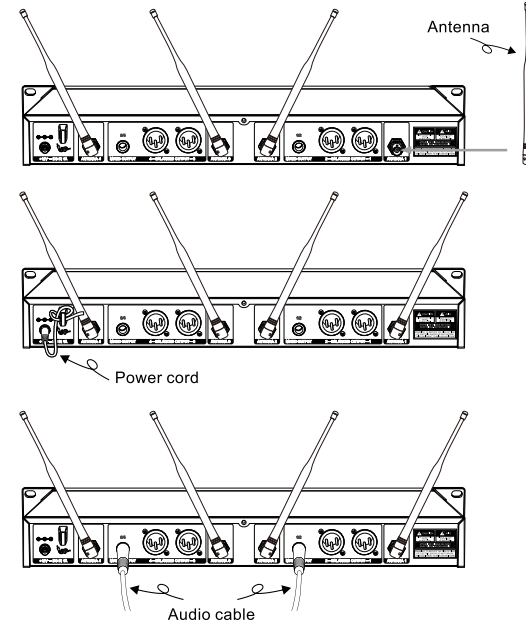

## 08 Transmitter Battery Installation

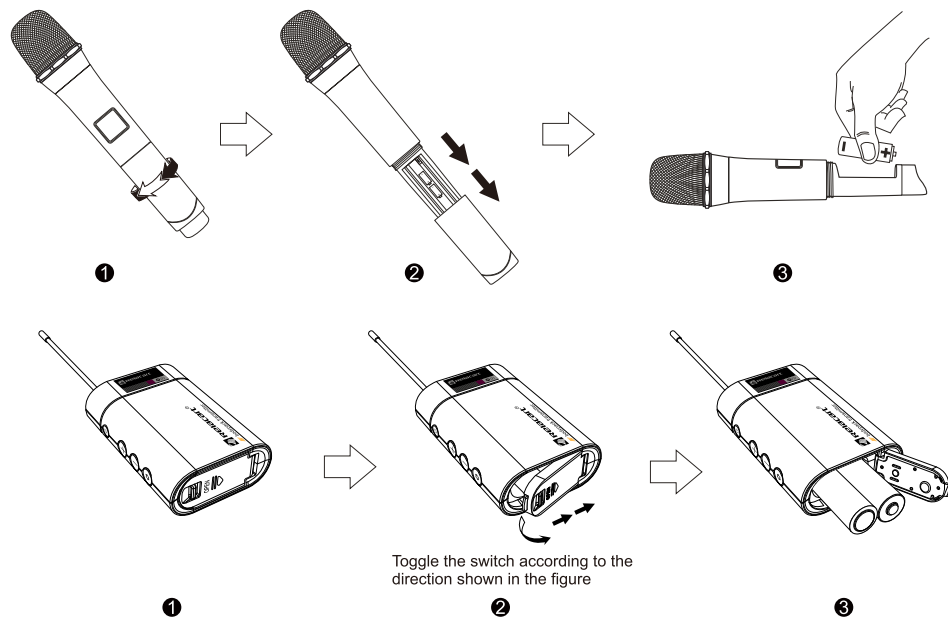

## 09 User-friendly Steps

1. After connecting the antenna and the power cable, press the power button to turn on the receiver. When the display is lit, the power is turned on successfully.

(EZ.Mi1 Single channel)

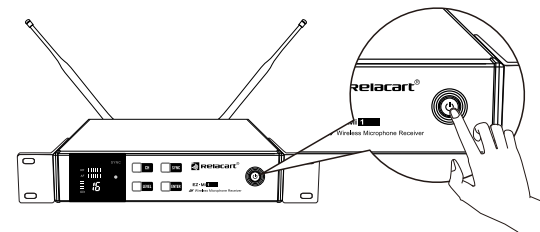

(EZ.Mi4 Quad channel)

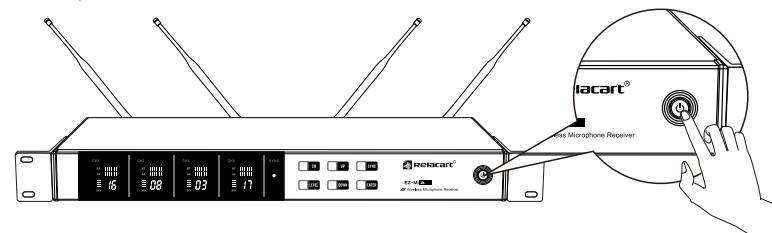

## 2. Channel settings

A. Single channel (EZ.Mi1): Long press the “CH” button of the receiver. When the channel display area is flashing, press the “CH” button to select the channel (each channel has 64 channels to choose from), confirm the setting and press “ENTER” Press the key to save.

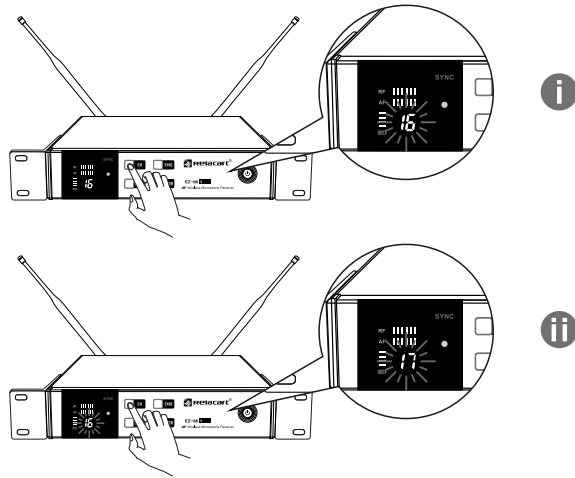

B. Dual/Quad channel (EZ.Mi2/EZ.Mi4): Long press the “CH” button of the receiver to enter the channel selection mode, and then short press to select the corresponding channel in turn; when the corresponding channel is selected, the channel display area will flash.

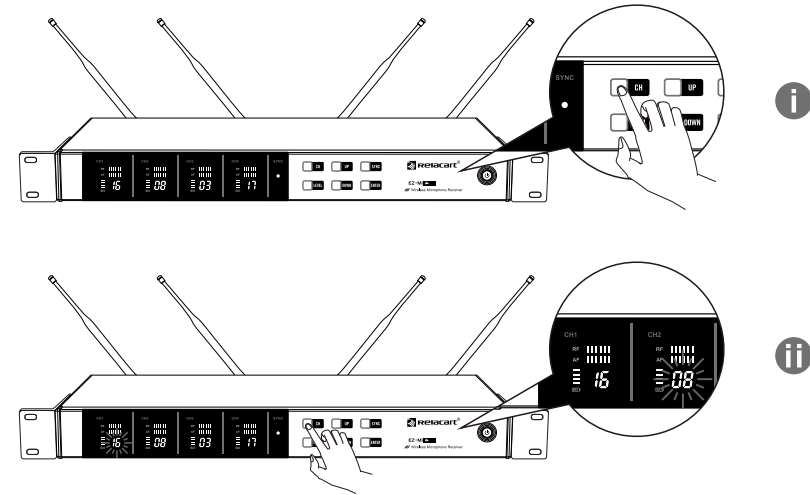

Short press the “CH” button to select the corresponding channel. When the channel display area is flashing, press the “UP/DOWN” control button to select the channel (each channel has 64 channels to choose from), confirm the setting and press “ENTER” Press the key to save.

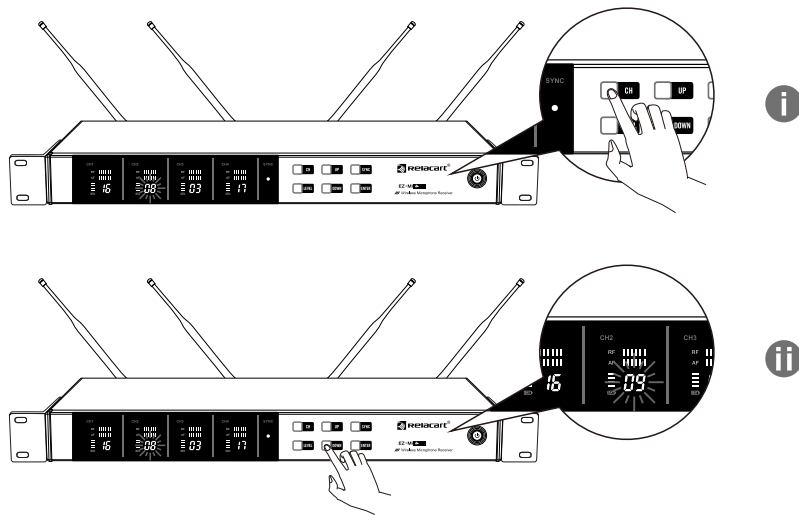

### 3. Audio level settings

A. Single channel (EZ.Mi1): Short press the “LEVEL” button of the receiver. When the AF display area is flashing, press the “LEVEL” button to set the level (each channel has 6 levels for selection), confirm the setting and press “ENTER” Press the key to save.

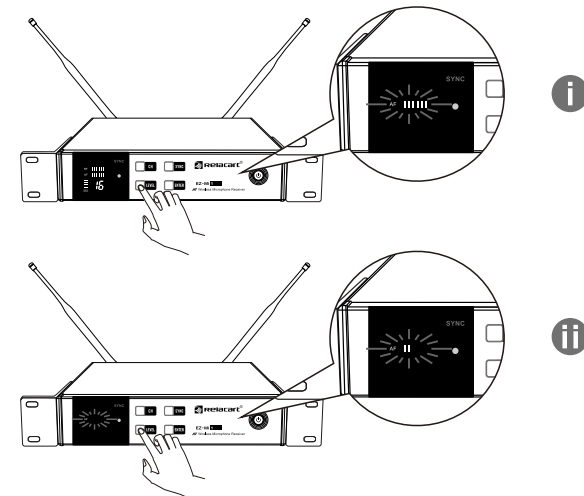

B. Dual/Quad channel (EZ.Mi2/EZ.Mi4): Long press the “ LEVEL ” button of the receiver to enter the level selection mode, and then short press to select the level of the corresponding channel in turn; when the corresponding channel level is selected, the AF display area will flash.

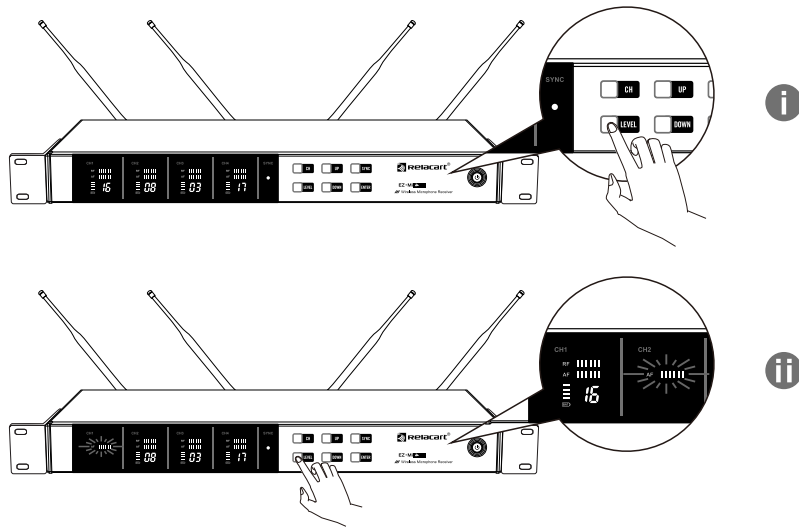

Short press the “ LEVEL ” button to select the corresponding channel level. When the AF display area is flashing, press the “ UP/DOW ” control button to set the level (each channel has 6 levels for selection), confirm the setting by pressing the Press the “ ENTER ” button to save.

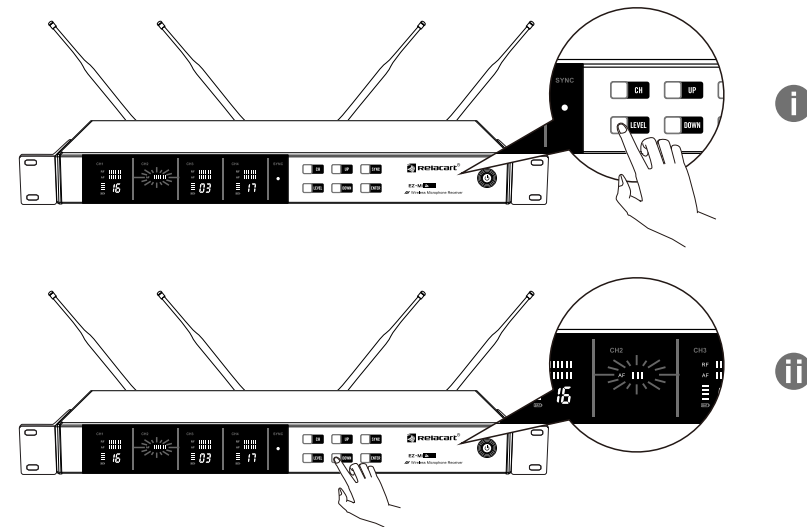

## 4. Infrared frequency Settings

A. Single channel (EZ.Mi1): Align the infrared window of the transmitter with the SYNC infrared window of the receiver, and press the " SYNC " button to enter the frequency synchronization. (During the synchronization process, the receiver SYNC window flashes)

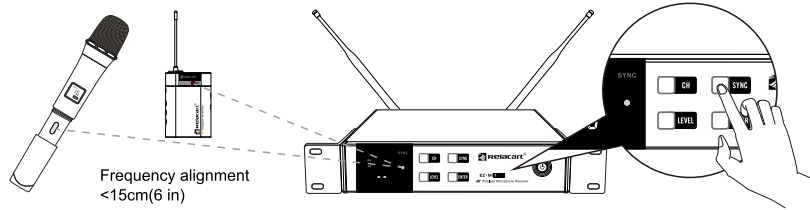

After the frequency synchronization between the transmitter and receiver is successful, the frequency of the transmitter is consistent with the frequency of the receiver; when the transmitter is used to speak, the " RF, AF " signal lights on the display screen jump to indicate that there is audio output.

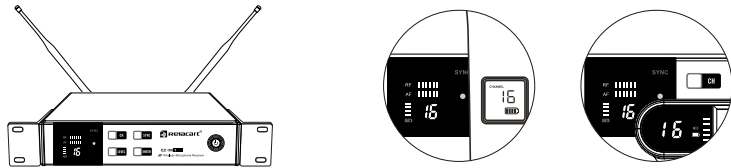

Channel display (receiver and transmitter display the same frequency)

B. Dual/Quad channel (EZ.Mi2/EZ.Mi4): Align the infrared window of the transmitter with the SYNC infrared window of the receiver, long press the " CH " button to enter the channel selection mode (flashing), then short press the " CH " button to select the corresponding frequency channel; and then press the " SYNC " button to enter the frequency synchronization. (During the synchronization process, the receiver SYNC window flashes)

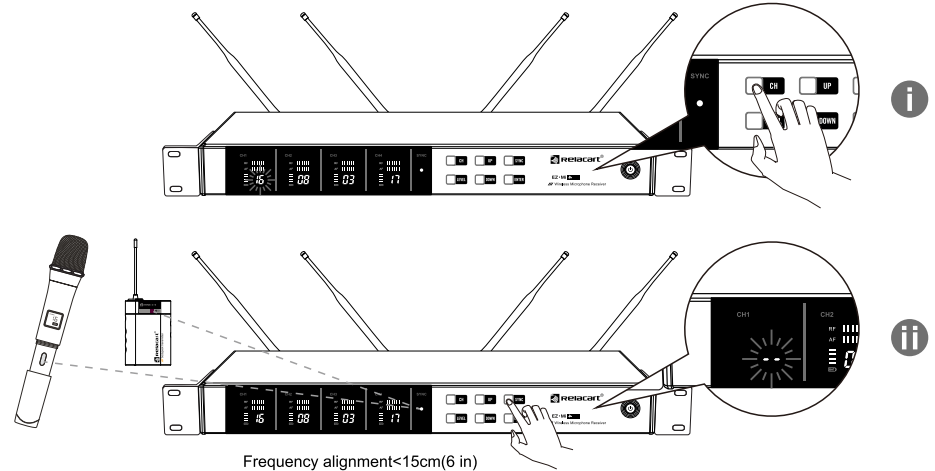

## 10 Technical Specification

After the frequency synchronization between the transmitter and receiver is successful, the frequency of the transmitter is consistent with the frequency of the receiver; when the transmitter is used to speak, the “ RF, AF ” signal lights on the display screen jump to indicate that there is audio output.

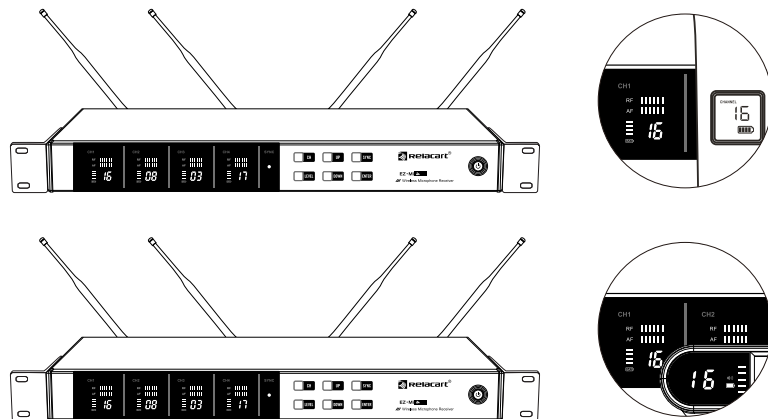

Channel display (receiver and transmitter display the same frequency)

### EZ.Mi series wireless microphone system

RF Carrier Frequency Range :	470MHz — 960MHz
Frequency Stability :	0.005%
Operating Range :	≥60m (environment dependent)
Audio Companding:	DSP digital audio companding
Audio Sampling Rate:	48KHz
Audio Frequency Response:	50Hz — 18000Hz ±3dB
Dynamic Range:	92 dB
S/N Ratio:	105 dB (A weight)
T.H.D :	≤0.8%, @1KHz
Operating Temperature Range:	-10°C — +50°C

## EZ.Mi1 Single channel wireless receiver

Main Frame Size :	EIA standard 1/2U
Receiving Bandwidth:	Single channel, Superheterodyne true diversity receiving
Image Rejection:	45dBm
RF Sensitivity:	10dBuV
Squelch Adjustment:	Built-in setting parameters
Frequency Sync Mode:	IR SYNC
Maximum Output Level:	LINE: 0.5Vpp
Adjustment Range of	6 levels adjustable, attenuation adjustment, every 3dB step
Audio Output Level:	
Power Requirements:	DC 12V/1A
Current Consumption:	DC 12V: 250mA
Dimension (mm) :	205 (W) x 195 (D) x 43 (H)
Weight:	About 990g

## EZ.Mi2/EZ.Mi4 Dual/Quad channel wireless receiver

Main Frame Size :	EIA standard 1U
Receiving Bandwidth:	Dual/Quad channel, Superheterodyne true diversity receiving
Image Rejection:	45dBm
RF Sensitivity:	10dBuV
Squelch Adjustment:	Built-in setting parameters
Frequency Sync Mode:	IR SYNC
Maximum Output Level:	LINE: 0.5Vpp
Adjustment Range of	6 levels adjustable, attenuation adjustment, every 3dB step
Audio Output Level:	
Power Requirements:	DC 12V/1A
Current Consumption:	EZ.Mi2: DC 12V, 250mA EZ.Mi4: DC 12V, 380mA
Dimension (mm) :	410 (W) x 212 (D) x 43 (H)
Weight:	EZ.Mi2: About 1.76Kg EZ.Mi4: About 1.95Kg

## EZ.H8 wireless handheld microphone

Switching Bandwidth:	470MHz — 960MHz
Frequency Generation:	PLL synthesized
RF Output Power:	13.5dBm
Carrier Deviation:	0.005%
Harmonic Emissions:	-32dBm
Modulation:	FSK
Nominal/Peak Deviation:	± 65KHz
Maximum Input Level:	250mV
Input Impedance:	2.2K $\Omega$
Frequency Set-up:	IR SYNC
Power Requirements:	AA 1.5V x 2
Current Consumption:	120mA
Battery Life:	≥10 Hours
Dimension (mm) :	49.5(Φ) × 236 (L)
Weight:	About 246g (w/o battery)

## EZ.B8 Wireless bodypack transmitter

Switching Bandwidth:	470MHz — 960MHz
Frequency Generation:	PLL synthesized
RF Output Power:	13.5dBm
Carrier Deviation:	0.005%
Harmonic Emissions:	-32dBm
Modulation:	FSK
Nominal/Peak Deviation:	± 65KHz
Maximum Input Level:	250mV
Input Impedance:	Mic 2.2K $\Omega$ , Line 4.7 K $\Omega$
Frequency Set-up:	IR SYNC
Volume adjustment:	4 levels adjustable, every 3dB step
Power Requirements:	AA 1.5V x 2
Current Consumption:	120mA
Battery Life:	≥8 Hours
Dimension (mm) :	198(H) x 52.5(W) x 28(D)
Weight:	About 50g (w/o battery)